

REGISTER SEARCH STATEMENT (Title Search) Transfer of Land Act 1958

Page 1 of 1

VOLUME 10767 FOLIO 647

Security no : 124109689900C
Produced 11/10/2023 01:23 PM

LAND DESCRIPTION

Lot 1 on Plan of Subdivision 510461T.
PARENT TITLE Volume 10056 Folio 876
Created by instrument PS510461T 28/11/2003

REGISTERED PROPRIETOR

Estate Fee Simple
Sole Proprietor
KYRITSIS SERVICES PTY LTD of 27-31 ANDERSON ROAD THORNBURY VIC 3071
AD678179X 14/06/2005

ENCUMBRANCES, CAVEATS AND NOTICES

COVENANT 2017891

Any encumbrances created by Section 98 Transfer of Land Act 1958 or Section 24 Subdivision Act 1988 and any other encumbrances shown or entered on the plan set out under DIAGRAM LOCATION below.

DIAGRAM LOCATION

SEE PS510461T FOR FURTHER DETAILS AND BOUNDARIES

ACTIVITY IN THE LAST 125 DAYS

NIL

-----END OF REGISTER SEARCH STATEMENT-----

Additional information: (not part of the Register Search Statement)

Street Address: 29 ANDERSON ROAD THORNBURY VIC 3071

DOCUMENT END

Stage No.

LR use only

PLAN NUMBER

PLAN OF SUBDIVISION

UNDER SECTION 35(B) OF THE SUBDIVISION ACT 1988

EDITION 1

PS 510461T

Location of Land

Parish: Jilka Jilka

Township: _____

Section: _____

Crown Allotment: _____

Crown Portion: 136 (Part)

LTO base record: D.C.M.B.

Title References:

C/T Vol. 10056 Fol. 876

Last Plan Reference: LOT 3 ON PS 311847E

Postal Address: 137 Fyffe Street,
Thornbury 3071

AMG Co-ordinates: E 321,970m

(Of approx. centre of plan) N 5,819,460m Zone 55

Vesting of Roads or Reserves

Identifier

Council/Body/Person

RESERVE No.1

MELBOURNE WATER
CORPORATION

Council Certification and Endorsement

Council Name: Darebin City Council

Ref: S 249/02 A

1. This plan is certified under section 6 of the Subdivision Act 1988.

~~2. This plan is certified under section 11(7) of the Subdivision Act 1988.~~~~Date of original certification under section 6~~3. This is a statement of compliance issued under section 21 of the
Subdivision Act 1988.

Open Space

(i) A requirement for public open space under section 18 of the
Subdivision Act 1988 has / has not been made.~~(ii) The requirement has been satisfied.~~~~(iii) The requirement is to be satisfied in Stage~~

Council Delegate

~~Council seal~~

Date 16/11/2003

~~Re-certified under section~~~~11(7) of the Subdivision~~~~Act 1988~~~~Council Delegate~~~~Council seal~~~~Date / /~~

Notations

Depth Limitation: Does not apply

Staging

This is/is not a staged subdivision
Planning Permit No.The land being subdivided is enclosed within thick
continuous lines.

Reserve No.1 is not subject to survey.

Survey:- This plan is / is not based on survey.

To be completed where applicable.

This survey has been connected to permanent mark(s) no(s).

In Proclaimed Survey Area no.

Easement Information

Legend:

E - Encumbering Easement or Condition in Crown Grant in the Nature of an Easement
A - Appurtenant Easement R - Encumbering Easement (Road)

Easement Reference	Purpose	Width (Metres)	Origin	Land Benefited/In Favour Of
1	SEWERAGE, DRAINAGE AND WATER SUPPLY	SEE DIAG.	INST. 2558137	MMBW
2	SEWERAGE	SEE DIAG.	THIS PLAN	YARRA VALLEY WATER LIMITED
2	SEWERAGE	SEE DIAG.	PS 311847E	MMBW
3	ELECTRICITY SUPPLY	SEE DIAG.	INST. 2024040	SECV
3	SEWERAGE	SEE DIAG.	PS 311847E	MMBW
3	ELECTRICITY SUPPLY	SEE DIAG.	INST. 2024040	SECV
3	SEWERAGE, DRAINAGE AND WATER SUPPLY.	SEE DIAG.	INST. 2558137	MMBW
SEE SHEET 2 FOR CONTINUATION				

LR use only

Statement of Compliance
/ Exemption Statement

Received



Date 27/08/2003

LR use only

PLAN REGISTERED

TIME 11:14 AM

DATE 28/11/2003

Garry P. Smith
Assistant Registrar of Titles

Sheet 1 of 3 Sheets

LICENSED SURVEYOR MALCOLM JOHN PERRIAM

REF 6200/4/01

VERSION 1

DATE 21/11/2002

SIGNATURE

benchmark
IN QUALITY
AS/NZS 1509001

PEYTON WAITE

CONSULTING LAND SURVEYORS & TOWN PLANNERS

353 PLENTY ROAD PRESTON 3072 PHONE 94784933 FAX 94706992 A.C.N. 004 963 804

CERTIFIED QUALITY SYSTEM - ISO 9001:1994 Cert No.842

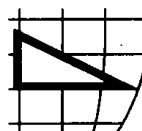

6200401.LCD

DATE / /

COUNCIL DELEGATE SIGNATURE

Original sheet size A3

PLAN OF SUBDIVISION

UNDER SECTION 35(8) OF THE SUBDIVISION ACT 1988

Stage No.

Plan Number

PS 510461T

Easement Information

Legend: A - Appurtenant Easement E - Encumbering Easement R - Encumbering Easement (Road)

Easement Reference	Purpose	Width (Metres)	Origin	Land Benefited/In Favour Of
E-3	SEWERAGE	SEE DIAG.	THIS PLAN	YARRA VALLEY WATER LIMITED
E-4	ELECTRICITY SUPPLY	SEE DIAG.	INST. 2024040	SECV
	SEWERAGE, DRAINAGE AND WATER SUPPLY.	SEE DIAG.	INST. 2558137	MMBW
E-5	SEWERAGE	SEE DIAG.	THIS PLAN	YARRA VALLEY WATER LIMITED
	ELECTRICITY SUPPLY	SEE DIAG.	INST. 2024040	SECV
E-6	SEWERAGE	SEE DIAG.	PS 311847E	MMBW
	ANY EASEMENTS AFFECTING THE SAME	SEE DIAG.	Vol. 3814 Fol. 601 & LP 6434	LOTS ON LP 6434
E-7	SEWERAGE	SEE DIAG.	PS 311847E	MMBW
	ANY EASEMENTS AFFECTING THE SAME	SEE DIAG.	Vol. 3814 Fol. 601 & LP 6434	LOTS ON LP 6434
	ELECTRICITY SUPPLY	SEE DIAG.	INST. 2024040	SECV
E-8	DRAINAGE	SEE DIAG.	PS 311847E	CITY OF NORTHCOTE
E-9	SEWERAGE	SEE DIAG.	THIS PLAN	YARRA VALLEY WATER LIMITED

ORIGINAL

SHEET SCALE

3

SCALE

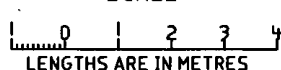

LICENSED SURVEYOR MALCOLM JOHN PERRIAM

SIGNATURE _____

DATE 21/11/2002

REF 6200/4/01

VERSION 1



benchmark
IN QUALITY
AS/NZS 15090:01

PEYTON WAITE

CONSULTING LAND SURVEYORS & TOWN PLANNERS

353 PLENTY ROAD PRESTON 3072 PHONE 94784933 FAX 94706992 A.C.N. 004 963 884

CERTIFIED QUALITY SYSTEM - ISO 9001:1994 Cert No. 842

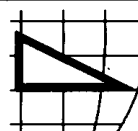

6200401.LCD

SHEET 2 OF 3 SHEETS

DATE / /

COUNCIL DELEGATE SIGNATURE

PLAN OF SUBDIVISION

UNDER SECTION 35(8) OF THE SUBDIVISION ACT 1988

Stage No.	Plan Number
-----------	-------------

PS 510461T

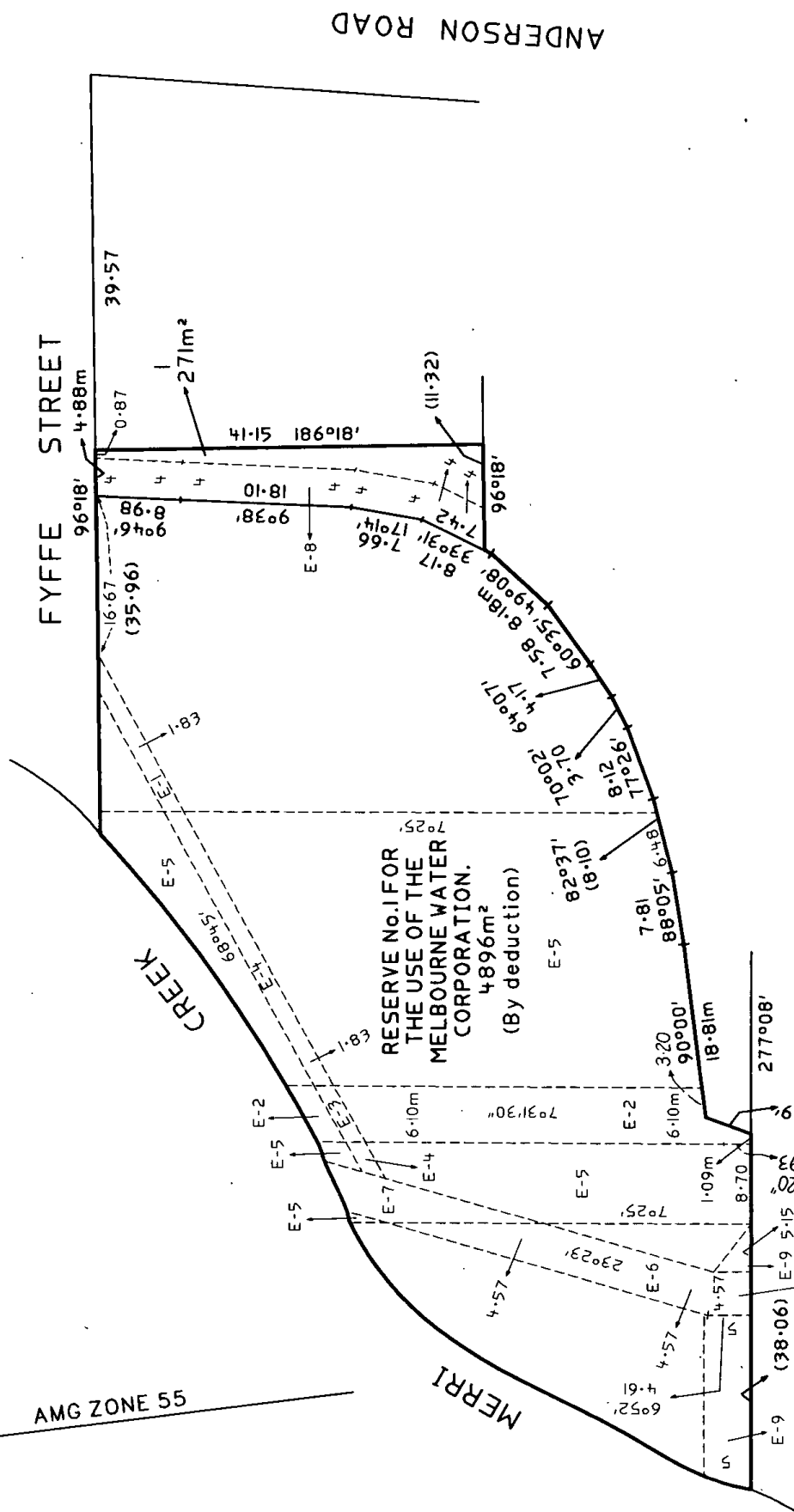

ORIGINAL	SHEET SCALE
A3	1:500

SCALE
0 5 10 15 20
LENGTHS ARE IN METRES

SHEET 3 OF 3 SHEETS

LICENSED SURVEYOR MALCOLM JOHN PERRIAM

DATE 21/11/2002

DATE	COUNCIL
11/11/11	11/11/11

COUNCIL DELEGATE SIGNATURE



PEYTON WAITE

CONSULTING LAND SURVEYORS & TOWN PLANNERS

3533 PLENTY ROAD PRESTON 3072 PHONE 94784933 FAX 94706992 A.C.N. 004 963 884

CERTIFIED QUALITY SYSTEM - ISO 9001:1994 Cert No. 842

62004011 CD

REF 6200.

100